

**THE
NATIONAL
BOARD**

OF BOILER AND
PRESSURE VESSEL
INSPECTORS

June 14, 2012

Mr. Stephen Smith
Valvtechnologies, Incorporated
5904 Bingle Rd
Houston, TX 77092

**Subject: Renewal of Capacity Certification, Valve Type E*9121 (NB Cap.
Cert ID No.: VLC-M59060)**

Dear Mr. Smith,

We have reviewed the application for renewal of capacity certification for the subject valve type dated June 9, 2012 and drawings and additional information submitted 6/13/12. Since the flow path is unchanged and no functional testing of power operated valves is required, all requirements for recertification have been met.

Valvtechnologies, Incorporated is hereby granted capacity certification and authorization to apply the "NB" mark to the valve type listed in the scope of certification. This authorization is valid for the above location and only while the organization holds a current ASME "V" Certificate of Authorization and is fully implementing its quality system as accepted by the National Board.

SCOPE OF CERTIFICATION

VALVE TYPE: E*9121

Organization Type: Manufacturer

Certified Rating Value: Slope = 143.2 PPH/PSIA

Size: 2-1/2" x 2.125" bore x 4"

Pressure Range: 15 through 5000 psig

Certification Expiration Date: June 16, 2018

1055 CRUPPER AVE.

COLUMBUS, OHIO

43229-1183

U.S.A.

614.888.8320

EXECUTIVE
Fax 614.888.0750

TECHNICAL
Fax 614.847.1828

PRESSURE RELIEF DEPT.
Fax 614.848.3474

ORDER DEPARTMENT
Fax 614.847.1147

TRAINING DEPARTMENT
Fax 614.847.5542

EMAIL
information@nationalboard.org

WEB SITE
nationalboard.org

Yours truly,

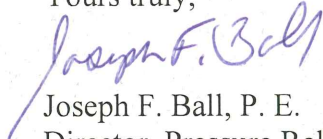
Joseph F. Ball, P. E.

Director, Pressure Relief Department

REF: VLC-M59060ren6-12.docx



May 3, 2012

Mr. Stephen Smith
Valvetechnologies, Incorporated
5904 Bingle Rd
Houston, TX 77092
UNITED STATES

Subject: **EXPIRATION NOTICE**

**THE
NATIONAL
BOARD**

OF BOILER AND
PRESSURE VESSEL
INSPECTORS

**YOUR COMPANY IS AT RISK OF LOSING
CAPACITY CERTIFICATION**

This is to serve as a reminder that permission to apply the National Board "NB" mark and ASME Code Symbols will soon expire on the date indicated on the attached notification table. To renew this permission for an additional six-year period, testing of sample production valves, selected by a National Board representative, must be successfully completed.

There will be no penalty for testing early. You must test up to six months prior to the expiration date, the renewed six-year period will commence on the expiration date of the previous period.

Please review, correct as necessary and sign the enclosed application(s) and return with a **(NON-REFUNDABLE)** application fee of \$100.00, per device type. After our review and receipt of the required fees, we will contact you to schedule a visit to your facility.

Manufacturers: Please note any corrections or modifications to the certification, which will be used to update our NB-18 records. Also, item "H" indicates a current assembly drawing and parts list, including material specifications, must be attached.

IMPORTANT NOTE:

No extensions are given beyond the expiration date for capacity certifications. If re-certification is not completed by this date, your authorization to apply the "NB" mark to your valves will no longer be valid.

If you have any questions or concerns, please feel free to call our office.

If you have already submitted these applications, please disregard this notice.

Cordially,

Melody K. Fulton
Administrative Secretary,
Pressure Relief Department
Enclosure(s)

1055 CRUPPER AVE.

COLUMBUS, OHIO

43229-1183

U.S.A.

614.888.8320

EXECUTIVE
Fax 614.888.0750

TECHNICAL
Fax 614.847.1828

PRESSURE RELIEF DEPT.
Fax 614.848.3474

ORDER DEPARTMENT
Fax 614.847.1147

TRAINING DEPARTMENT
Fax 614.847.5542

EMAIL
information@nationalboard.org

WEB SITE
nationalboard.org

Device Certs Expiration Summary

Valvtechnologies, Incorporated (VLC)

VLC

Addr: Mr. Stephen Smith
Valvtechnologies, Incorporated
5904 Bingle Rd
Houston, TX 77092
UNITED STATES

EXPIRED

<i>Cert #</i>	<i>exp date</i>	<i>App Received</i>	<i>App #</i>	<i>design name</i>	<i>status</i>
59048	12/06/2004	07/26/2004		E***21*30BWRF**	Not Created

Within 3 Months

<i>Cert #</i>	<i>exp date</i>	<i>App Received</i>	<i>App #</i>	<i>design name</i>	<i>status</i>
59037	06/09/2012		VLC59037-18	ERV 3 1/16" Bore	New
59060	06/16/2012	02/08/2007	VLC59060-11	E*9121	Received\$

7 months

<i>Cert #</i>	<i>exp date</i>	<i>App Received</i>	<i>App #</i>	<i>design name</i>	<i>status</i>
59082	12/04/2012		VLC59082-18	EOL121NRA*P1-MK1H	New



5904 Bingle Road
Houston, TX 77092
Phone: +1 713 860 0400
Fax: +1 713 860 0499
www.valv.com

June 4, 2012

Mr. Joseph F. Ball, P.E.

Director, Pressure Relief Department
The National Board of Boiler and Pressure Vessel Inspectors
1055 Crupper Ave.
Columbus, OH 43229-1183

Subject: Renewal of Capacity Certification, Valve Type: E*9121
(NB Cap Cert No -59060)

Dear Mr. Ball:

We have received your Expiration notice for the above referenced capacity certification.

In renewing this application we have reviewed the design and no changes have been made to the flow path design of the valve.

Please find attached the following documentation supporting our application to renew the capability certification for 6 years.

- This letter stating no changes have been made to the design or flow path.
- A copy of drawing E9121 for EB9121N7BWRA6P1 dated 06/08/12 Size: 2-1/2" x 2-1/8" bore x 4"
- Completed National Board Control Sheet (Based on conversation with you we were informed no audit is planned at this time).
- Completed Application for National Board Certification of a Pressure Relief Device Design and Authorization To Use the "NB" Mark
- Completed National Board Payment Options

If you have any questions, please feel free to contact us at any time.

Sincerely,

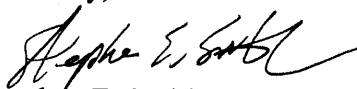

Stephen E. Smith, P.E.
Director of Engineering

cc: Craig Walther, Ryan Carbonara, Ron Holderman

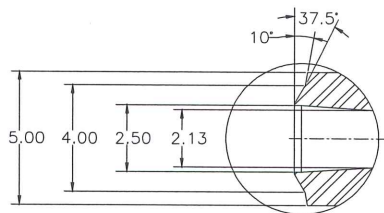
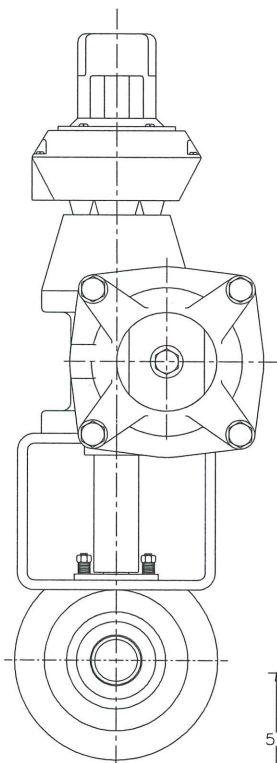
*SUBMITTED
JUN 8, 2012*

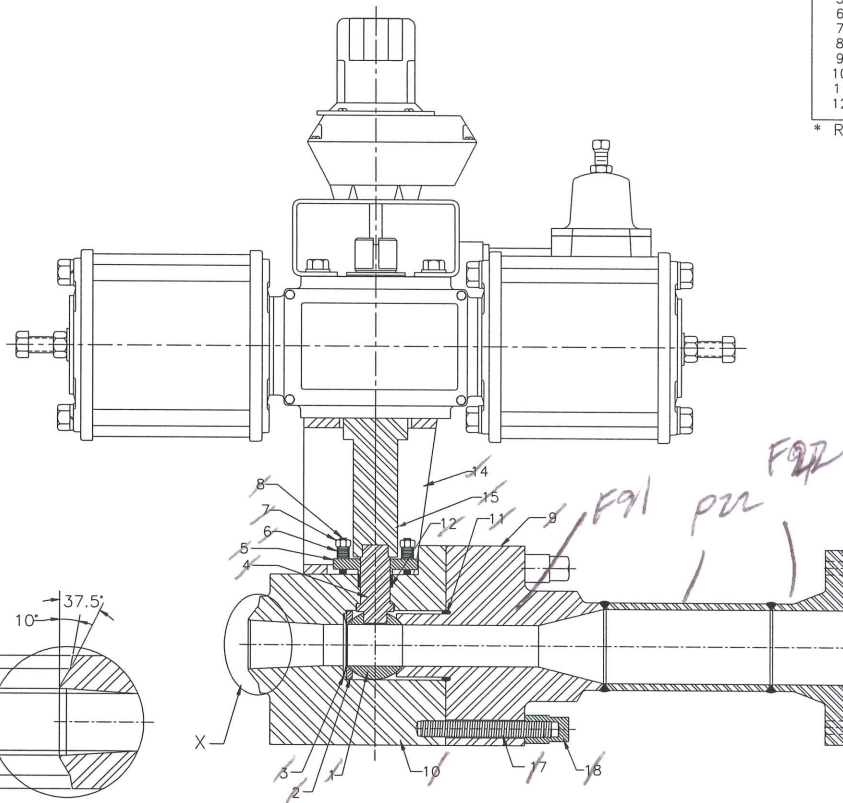

DETAIL X



FLOW UP
AS INSTALLED

BILL OF MATERIAL			
ITEM	DESCRIPTION	MATERIAL	QTY.
1	BALL	SB637/RAM31	1*
2	UPSTREAM SEAT	SA182-F22/OPQ	1*
3	BELLEVILLE SPRING	SB637	1*
4	STEM	SA638/OPQ	1
5	GLAND	SA182-F22/OPQ	1
6	GLAND LOAD SPRING	SA666	24
7	GLAND NUT	SA194 Gr. 8M	4
8	GLAND STUD	SA193 Gr. 8M	4
9	END CAP	SA182-F91/RAM31	1*
10	BODY	SA182-F91	1
11	BODY GASKET	SA564	1
12	GLAND PACKING	SA182-316/GRAFOIL	1*

* Recommended Spare Parts

9 END CAP SA182-F91/RAM31
 PIDE SA 335 P22
 FLANG SA182-F22
 10
 11
 12
 13
 14 MOUNTING BRACKET AS00 PLATE (STEEL)
 15 DRIVE SLEEVE SA29 GR 4130/OPQ
 16
 17 BODY STUD SA193 GR 8M
 18 BODY NUT SA-182-316

**Release For Customer Approval

<p>THIRD ANGLE PROJECTION</p>	-	-	-	-	-	-	-	DIMENSIONS ARE IN INCHES REMOVE BURRS AND BREAK EDGES UNLESS OTHERWISE SPECIFIED	SCALE 6:1	MODEL FILE	SIZE B	VALVTECHNOLOGIES 5904 BINGLE ROAD, HOUSTON TEXAS 77092 PH: (713) 860-0400 FAX: (713) 860-0499
	-	-	-	-	-	-	-		CORNER RADII - .X= ± - .XX= ± - .XXX= ± - CONCENTRICITY ± - ANGULAR ± - SURFACE TEXTURE ± - MIN. INTERNAL FILLETS -	COATING	-	
THIS DRAWING AND THE INFORMATION CONTAINED WITHIN IS CONSIDERED TO BE CONFIDENTIAL AND THE SOLE PROPERTY OF VALVTECHNOLOGIES. THE CONTENTS OF THIS DRAWING MAY NOT BE REPRODUCED OR DISCLOSED VERBALLY OR OTHERWISE OUTSIDE THE HOLDERS OFFICE WITHOUT THE WRITTEN APPROVAL OF VALVTECHNOLOGIES.	REV	DATE	DESCRIPTION	ECN	BY	CHK	APR	DRAWN BY RSL DATE 06/08/12 CHECKED BY RSL DATE 06/08/12 ENGINEER SES DATE 06/08/12 APPROVED BY SES DATE 06/08/12	EB9121N7BWRA6P1, ANSI 4500# 2.5" BW INLET X4" 600# OUTLET		E9121 SH 1 OF 1	



Application for National Board Certification of a Pressure Relief Device
Design and Authorization To Use the "NB" Mark

Part 1 General Information

We are making application to the National Board of Boiler and Pressure Vessel Inspectors to obtain National Board certification and permission to use the National Board "NB" mark on the device design described below.

Company Name: VALUTECHNOLOGIES, INCORPORATED (VLC)

Address: 5904 BINGLE ROAD
HOUSTON, TX 77092
UNITED STATES

hereby applies for device certification as [X] Manufacturer of [X] Pressure Relief
[] Assembler [] Rupture Disk Devices
[] Other Devices

of device type ERV 2 1/8" BORE (EX9121)
(Manufacturer's Series or Catalog Number or Identification)

Designed by VALUTECHNOLOGIES, INCORPORATED (VTC)
(Manufacturer's Name)

and described in Part 2 on the reverse side of this application (Manufacturers Only).

This certification is to be considered for:

Certified Medium: [X] Steam [] Air [] Gas [] Liquid (Note Liquid fluid scope PRVs, are certified
seperate from compressed fluid scope PRVs)
or list:

Construction Code Sections: [X] ASME Section I
[] ASME Section III; Subsection [] NB [] NC [] ND [] NE
[] ASME Section IV
[] ASME Section VIII, Division 1
[] ASME Section VIII, Division 3
[] ASME Section XII

Code Cases:

and is a(n) [] Initial Device Certification [] Transfer of Auth. (Move) [] Design Type Scope Change
[X] Six Year Certification Renewal - NB Cert No. 59060
Exp. Date JUNE 16, 2012

We certify that devices of the above noted type will be manufactured or assembled in accordance with the
Construction Code and our National Board accepted quality system.

Stephen E. Swartz
(Company Representative Signature)

JUNE 9, 2012
(Date)

National Board Office Use

Company Acct I.D. Company Code Design Id Number:
Application Reviewed By. Date:
Design Reviewed and Accepted By. Date:
Certification Fee received on: Application ID:

National Board Application for Certification

Part 2 Scope of Design (To be completed by Manufacturers Only)

A. Device Manufacturer: VALUTECHNOLOGIES INCORPORATED (VLC) Type/Model: ERV 2 1/8" BORE (EX9121)
 Plant Location: 5904 BINGLE ROAD HOUSTON, TX 77092, UNITED STATES

- B. Device Type:
- (1) Reclosing Types: Safety Valve Safety Relief Valve Relief Valve Pilot Operated Pressure Relief Valve
 Temperature Actuated Pressure Relief Valve Vacuum Relief Valve Power Actuated Pressure Relief Valve
- Other: _____
- (2) Non-Closing Types: Rupture Disk Device Buckling Pin Device Breaking Pin Device
- (3) Special Service Conditions None Forced Flow Steam Generator or High-Temperature Water Boilers (10% BD)
 Organic Fluid Vaporizers Low Pressure Steam Heating Boilers (15 psi)
 Economizer Service Non-Refrigerated Liquefied Compressed Gases (20% O.P.)

C. Set Pressure Definition:

Popping Start-to-Leak Initial Audible Discharge Bubble First Steady Stream First Heavy Flow
 Burst Pressure Buckling Pressure Breaking Pressure Other: POWER ACTUATED
 (Describe Physical Observations by Seeing, Hearing, Feeling)

D. Blowdown Characteristic:

Fixed Adjustable Adjustable and Fixed for Mod. Pilot N/A
 Adjustable by: Single Ring Dual Ring Other _____
 (Describe)

E. Flow Area Configuration:

Nozzle/Full Lift Curtain Area Restricted Lift Minimum Net Flow Area Annulus

F. Scope of Nominal Size and Set Pressure Ranges: (For additional sizes, attach supplemental sheet)

Inlet Size(s)	Outlet Size(s)	Flow Area*	Orifice [designator] diameter	Lift	Set Pressure Range	Media	Code Section(s)
2NPS	4NPS	3.547 sq in	2.125 in		15-5000 PSIG	STEAM	1

*For Rupture Disk devices, list minimum net flow

G. Materials of Construction

Part Key: H=Body/Holder; B= Bonnet; Y= Yoke

Key	Type	Grade

Key	Type	Grade

Key	Type	Grade

H. Design Drawing/Specification Number and Revision Level _____
 (Note: Please attach current parts list with material specifications and drawings)

I. Design Options: Describe options and variations which will be included (i.e. bellows, seat configuration, lifting lever option, etc.)

J. Test Medium: Steam Air Gas Liquid Water

K. Certification Method: Flow Capacity Rating by; Coeff. of Discharge K Slope Flow Factor
 3 Valve Average Single Valve Method
 Single Size Resistance Factor Rating; K_{RG} K_{RGL} K_{RL}
 Three Size Resistance Factor Rating; K_{RG} K_{RGL} K_{RL}

L. Certification Rating Value with unit of measure: 143.2 PPH/PSIA
 (Value) (Units)

M. (Renewals Only) Check only one box:
 We certify the flow path and performance of this design have not been changed.
 Changes as attached have been made to this design (attach supplement).
 Signature: Stephen E. Galt date: 6/8/12

Stephen Smith

From: Stephen Smith
Sent: Wednesday, June 13, 2012 2:23 PM
To: 'JBall@nationalboard.org'
Subject: RE: Renewal Application, 2-1/8" bore (Cert. No. VLC-M59060)

Attachments: E9121.pdf



E9121.pdf (143 KB)

Dear Mr. Ball,

Thank you for your assistance in processing our renewal application.

1. Line E: You are correct that the flow area configuration is "nozzle/full bore" since the internal diameter of the ball determines the flow area.
2. Line F: You are correct that the inlet size is 2-1/2 NPS, and the drawing shows this.
3. The bill of material on drawing E9121 does not have part numbers 13 through 18. We are providing an updated drawing E9121 Rev 1 clarifying the materials of construction for all parts. I have attached the updated drawing. Please note that item 13 is a structural tube mounting bracket used to mount the actuator to the valve. Item 14 is a drive sleeve designed to connect the valve stem to the actuator.

Sincerely,

Stephen E. Smith, P.E.
Director of Engineering
VALVTECHNOLOGIES, INC.
713-860-0472 office
832-518-0763 cell
713-860-0499 fax
www.valv.com

-----Original Message-----

From: JBall@nationalboard.org [mailto:JBall@nationalboard.org]
Sent: Wednesday, June 13, 2012 8:35 AM
To: Stephen Smith
Subject: Renewal Application, 2-1/8" bore (Cert. No. VLC-M59060)

Dear Mr. Smith,

In review of the application and supporting information for the subject certification we have the following comments.

1. Line E: The flow area configuration is "nozzle/full bore" since the internal diameter of the ball determines the flow area. We have marked the application accordingly.
2. Line F: Our records show the inlet size to be 2-1/2 NPS, and the drawing appears to show this as well.
3. The bill of material on drawing E9121 does not have part numbers 13 through 18. We need the material specifications for all those parts. Also, part no. 9 is shown as a forging specification, however it is a three part assembly. We need the material specification for each part.

Upon receipt and acceptance of information to address item 3 above we will process the renewal applicaion. Please call if there are any questions.

Sincerely,

Joseph F. Ball, P. E.
Director, Pressure Relief Department

National Board Testing Laboratory
7437 Pingue Drive
Worthington OH 43085

National Board Main Phone: 614-888-8320
Direct line phone no.: 614-431-3209
Jball@nationalboard.org
<http://www.nationalboard.org>
Fax: 614-848-3474



**THE
NATIONAL
BOARD**

OF BOILER AND
PRESSURE VESSEL
INSPECTORS

DONALD E. TANNER,
EXECUTIVE DIRECTOR

April 24, 2007

Mr. Richard Butler
Valvtechnologies, Incorporated
5904 Bingle Rd
Houston, TX 77092

**Subject: Renewal of Capacity Certification, Valve Type E*9121 (NB Cap.
Cert ID No.: VLC-M59060)**

Dear Mr. Butler,

We have reviewed the application for renewal of capacity certification for the subject valve type dated January 18, 2007. Since the flow path is unchanged and no functional testing of power operated valves is required, all requirements for recertification have been met.

Valvtechnologies, Incorporated is hereby granted capacity certification and authorization to apply the "NB" mark to the valve type listed in the scope of certification. This authorization is valid for the above location and only while the organization holds a current ASME "V" Certificate of Authorization and is fully implementing its quality system as accepted by the National Board.

SCOPE OF CERTIFICATION

VALVE TYPE: E*9121

Organization Type: Manufacturer

Certified Rating Value: Slope = 143.2 PPH/PSIA

Size: 2-1/2" x 2-1/8" bore x 4"

Pressure Range: 15 through 5000 psig

Certification Expiration Date: June 16, 2012

1055 CRUPPER AVE.
COLUMBUS, OHIO
43229-1183
U.S.A.
614.888.8320

EXECUTIVE
Fax 614.888.0750

TECHNICAL
Fax 614.847.1828

PRESSURE RELIEF DEPT.
Fax 614.848.3474

ORDER DEPARTMENT
Fax 614.847.1147

TRAINING DEPARTMENT
Fax 614.847.5542

EMAIL
getinfo@nationalboard.org

WEB SITE
nationalboard.org

Yours truly,

Joseph F. Ball, P. E.
Director, Pressure Relief Department

REF: VLC-M59060ren4-07