



STOCK NEXTECH® R SERIES

Technical Data	
Sizes	2-8"
Pressure Classes	ASME / ANSI Class 300 - 600
Temperature Range	-50 to 1100°F (-45 up 593°C)
Materials of Construction	Carbon steel (216WCC/LCC) - standard Alloy steel (WC6) - standard Stainless steel (316) CF8M Other materials upon request
In Compliance	ASME B16.34 PED API 6A API 6D
End Connections	Raised face – standard Others available upon request

CV'S

Valve Nominal Size	Pipe ID	Bore	Cv Based on Pipe ID	Max Cv of Valve
2"	2" sch 40	2.13	458	492
3"	3" sch 40	3.06	1,046	1,111
4"	4" sch 40	4.06	2,060	2,240
6"	6" sch 40	6.06	5,119	5,536
8"	8" sch 40	8.06	9,763	10,434

This table gives the Cv based on industry standard pipe and also the maximum Cv of the valve only. For Cv with other pipe I.D. or bore size, consult factory. Cv values are approximate, contact factory for exact Cv values.

PRESSURE / TORQUE RATINGS

Differential Pressure (psi)/Torque Values (in-lbs.)									
Valve size (inches)	Bore (inches)	0	100	200	500	1000	2000	3000	4000
2	2.13	1,045	1,190	1,497	2,420	3,960	7,040	10,120	13,200
3	3.06	2,180	2,930	3,677	5,910	9,650	17,120	24,590	32,060
4	4.06	4,270	5,270	6,277	9,280	14,300	24,320	34,350	44,370
6	6.06	5,000	6,530	9,070	16,700	29,360	54,720	80,090	105,450
8	8.06	9,740	15,270	20,797	37,370	65,000	120,260	175,530	230,790

GENERAL DIMENSIONS

NPS	A		B		C		D		E		F		G		Weight lbs.	
	300	600	300	600	300	600	300	600	300	600	300	600	300	600	300	600
2"	2.13	2.13	3.25	3.25	8.50	11.50	3.94	5.16	6.50	6.50	7.31	7.31	1.25	1.25	51	59
3"	3.06	3.06	4.25	4.25	11.12	14.25	5.31	6.84	8.25	8.25	8.69	8.69	1.50	1.50	102	120
4"	4.06	4.06	5.25	5.25	12.00	17.00	5.50	7.75	10.00	10.75	10.69	10.69	2.00	2.00	172	221
6"	6.06	6.06	7.25	7.25	15.88	22.00	7.63	10.94	12.50	14.00	14.13	14.09	2.50	2.50	370	501
8"	8.06	8.06	9.00	9.00	19.75	26.00	9.75	13.25	15.00	16.50	16.63	17.16	3.00	3.00	690	876

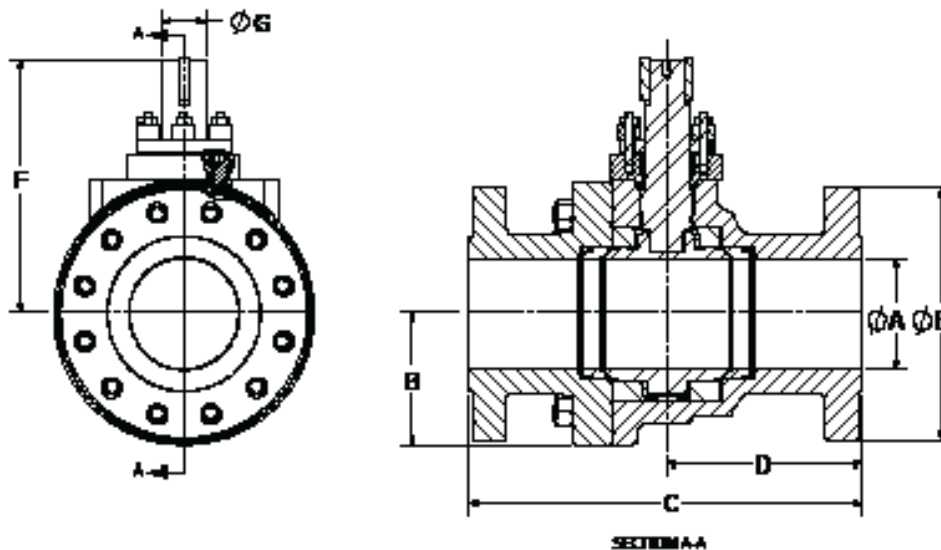

FEATURES

Live-loaded gland area. Featuring a four-stud, live-loaded assembly designed for heavy industrial applications. Ensures zero emissions from stem packing in the most severe applications.

True blow-out proof stem. Design utilizes a one-piece, hard-faced, blow-out proof stem that is inserted through the inside of the body cavity eliminating the possibility of blow-out through the gland area.

Absolute zero-leakage. Every valve tested per ANSI procedures; however, we toughen the standard and define zero-leakage as no detectable leakage of gas or a liquid for a period of three minutes or greater. The ValTechnologies' standard is zero drops and zero bubbles, guaranteed.

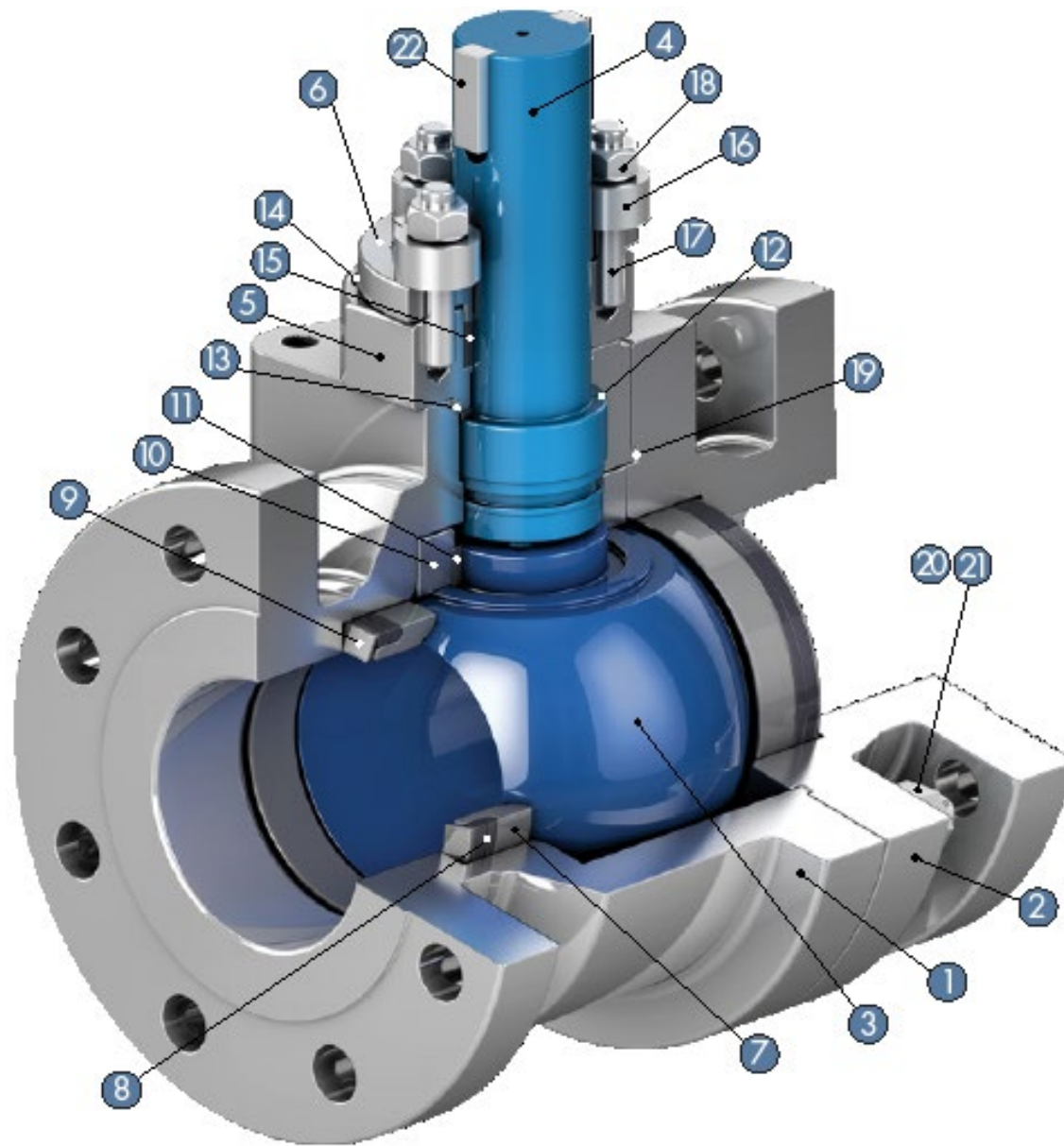

BILL OF MATERIALS

Item	Description	Trim Code					Qty
		22 (2-4") (1000 F max)	35 (6-8") (1000 F max)	CR (2-4") (800 F max)	CS (6-8") (800 F max)	J4 (2") (1100 F max)	
1	Body	SA-351 CF8M	SA-351 CF8M	SA-216 WCC/LCC	SA-216 WCC/LCC	SA-217 WC6	1
2	End cap	SA-351 CF8M	SA-351 CF8M	SA-216 WCC/LCC	SA-216 WCC/LCC	SA-217 WC6	1
3	Ball	SA-182 F316 HVOF RiTech® 21	SA-351 CF8M RiTech® 21	SA-182 F316 HVOF RiTech® 21	SA-351 CF8M RiTech® 21	SA-182 F316 HVOF RiTech® 21	1
4	Stem	SA-182 F316/Boronized	SA-182 CF8M F316/ Boronized	SA-182 F316/Boronized	SA-182 CF8M F316/ Boronized	SA-182 F316/Boronized	1
5	Bonnet	SA-182 F316	SA-182 F316	SA-29 Gr. 4130	SA-29 Gr. 4130	SA-182 F11 Cl.2	1
6	Gland	SA-182 F316/QPQ	SA-182 F316/QPQ	SA-182 F316/QPQ	SA-182 F316/QPQ	SA-182 F316/QPQ	1
7	Seat	SA-182 F316 HVOF RiTech® 21	SA-182 F316 HVOF RiTech® 21	SA-182 F316 HVOF RiTech® 21	SA-182 F316 HVOF RiTech® 21	SA-182 F316 HVOF RiTech® 21	2
8	Seat seal assembly	Grafoil®	Grafoil®	Grafoil®	Grafoil®	Grafoil®	2
9	Belleville® spring	SB-637 N07718	SB-637 N07718	SB-637 N07718	SB-637 N07718	SB-637 N07718	2
10	Upper/lower trunnion bearing	SA-182 F316/QPQ	SA-182 F316/QPQ	SA-105 /QPQ	SA-105 /QPQ	SA-182 F11 Cl.2/QPQ	2
11	Upper/lower sleeve bearing	SA-479 UNS S21800	SA-479 UNS S21800	SA-479 UNS S21800	SA-479 UNS S21800	SA-479 UNS S21800	2
12	Stem bearing	SA-479 UNS S21800	SA-479 UNS S21800	SA-479 UNS S21800	SA-479 UNS S21800	SA-479 UNS S21800	1
13	Bonnet gasket	Grafoil®	Grafoil®	Grafoil®	Grafoil®	Grafoil®	1
14	Bonnet cap screw	SA-193 B8M Cl. 1	SA-193 B8M Cl. 1	SA-193 B7	SA-193 B7	SA-193 B7	4
15	Gland packing	SB-637 N07718 Graphite	SB-637 N07718 Graphite	SB-637 N07718 Graphite	SB-637 N07718 Graphite	SB-637 N07718 Graphite/Teflon	1
16	Gland spring stack	SA-564 S17700 PH17-7	SA-564 S17700 PH17-7	SA-564 S17700 PH17-7	SA-564 S17700 PH17-7	SB-637 N07718	24
17	Gland stud	SA-193 B8M Cl. 1	SA-193 B8M Cl. 1	SA-193 B8M Cl. 1	SA-193 B8M Cl. 1	SA-193 B7/Xylan	4
18	Gland nut	SA-194 8M Cl. 1	SA-194 8M Cl. 1	SA-194 8M Cl. 1	SA-194 8M Cl. 1	SA-194 2H	4
19	Body gasket	Grafoil®	Grafoil®	Grafoil®	Grafoil®	Grafoil®	1
20	Body stud	SA-193 B8M Cl. 1	SA-193 B8M Cl. 1	SA-193 B7	SA-193 B7	SA-193 B7	8-16*
21	Body nut	SA-194 8M Cl. 1	SA-194 8M Cl. 1	SA-194 2H	SA-194 2H	SA-194 2H	8-16*
22	Key	SA-29 Gr 1018	SA-29 Gr 1018	SA-29 Gr 1018	SA-29 Gr 1018	SA-29 Gr 1018	2